

TWO WAY CLIPS WELDED TO VERTICAL STRUT

NOTE: ENSURE THAT THE VERTICAL STRUTS CAN CARRY THE WEIGHT OF THE STONE

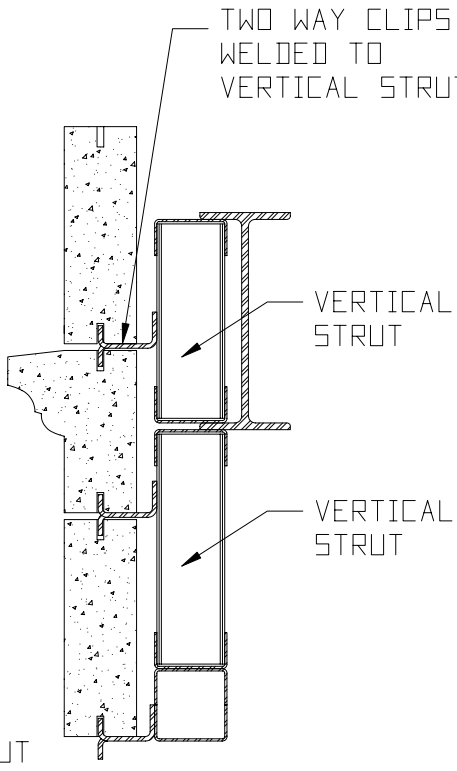

CROSS SECTION THROUGH STRUCTURE

KERF STONE TO ACCOMMODATE CLIP
(DO NOT KERF ON STONE CORNERS)

TWO WAY CLIPS WELDED TO STRUCTURE TO SUPPORT STONE

1

ATTACHMENT OF PANEL AND WATERTABLE TO STRUCTURAL STEEL WITH 2-WAY STRAPS